

INSTALLATION SECTION VIEW
* PREFERRED METHOD OF FILL SLOPE PLACEMENT

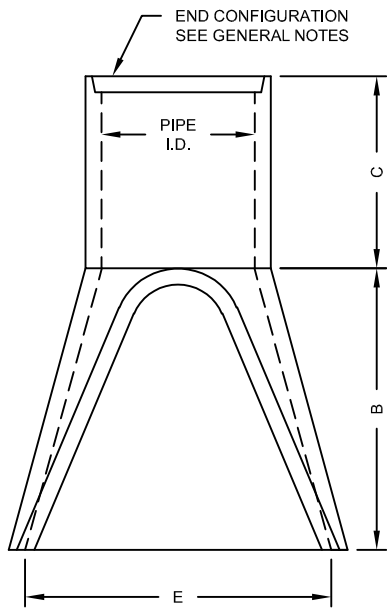

PLAN VIEW

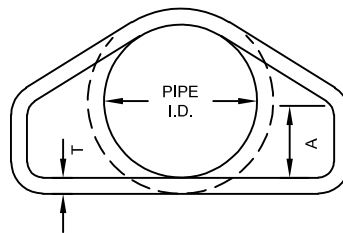

END VIEW

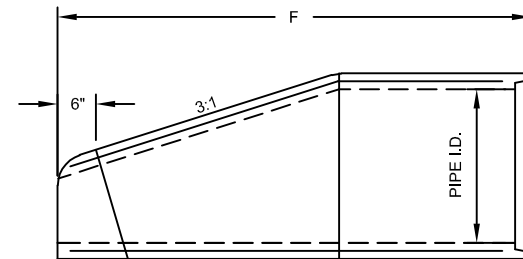

SECTION

DIMENSIONS FOR END SECTIONS						
PIPE I.D.	END SECTIONS					
	A	B	C	E	F	T
30"	1'-0"	4'-6"	1'-8"	5'-0"	6'-2"	3 1/2"
36"	1'-3"	5'-3"	2'-11"	6'-0"	8'-2"	4"
42"	1'-9"	5'-3"	2'-11"	6'-6"	8'-2"	4 1/2"
48"	2'-1"	6'-0"	2'-2"	7'-0"	8'-2"	5"

GENERAL NOTES:

- * FLARED END SECTION - END CONFIGURATION
- INLET LOCATION - TONGUE
- OUTLET LOCATION - GROOVE

* CONCRETE FOR FLARED END SECTION IS 4,000 PSI AT 28 DAYS



PROJECT:			
REINFORCED CONCRETE FLARED END SECTION			
TITLE: FLARED END SECTION			ID#: FES
CONTRACTOR:			REV 6/29/21
SCALE: N.T.S.	BY: NAH	DATE: 7/10/12	SHEET: 1 of 1